

WISE-710 Industrial Protocol Gateway with Freescale i.MX6 DualLite CPU, Dual GbE, 3 x COM, 4 x DI/O, 1 x Micro USB, and 1 x Micro SD Slot

Startup Manual

Packing List

Before installation, ensure that the following items are included with the product:

- 1 x 2-pin terminal block
- 1 x 5-pin terminal block
- 1 x 10-pin terminal block
- 2 x mount kit holder
- 2 x mount kit latch
- 4 x mount kit screw
- 1 x grounding cable
- 1 x China RoHs label
- 1 x WISE-710 startup manual
- 1 x warranty card

If any of these items are missing or damaged, contact your distributor or sales representative immediately.

Document/Software Support Guide

All relevant documentation and software are available on-line for download at <https://support.advantech.com/Support/SearchResult.aspx?keyword=wise-710>.

Documentation

- Datasheet
- Startup manual
- User manual

Image

- Yocto
- Ubuntu

For more information about this or other Advantech products, visit the Advantech website at

<http://www.advantech.com>

<http://www.advantech.com/eplatform>

For technical support and customer service, visit the Advantech support website at

<http://www.advantech.com/support>

This manual is for WISE-710.

Part No. 2043E71000

Edition 1
January 2019

Initial Setup

This manual contains the following sections, which provide information on how to conduct the initial device setup:

- DIN-Rail Installation
- Wall Mount Installation
- Wi-Fi Module and Antenna Installation
- Expansion Module Installation

DIN-Rail Installation

1. Fasten the DIN rail bracket to the gateway using 2 screws

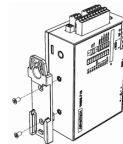

2. Install the mount latch

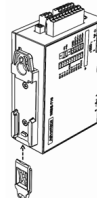

3. Use the DIN rail bracket to mount the gateway onto the DIN rail

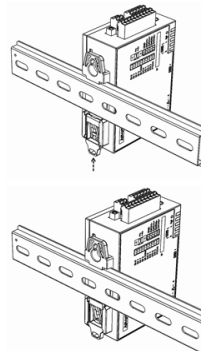

Wall Mount Installation

1. Fasten the wall mount brackets to the gateway using 4 screws

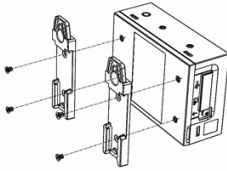

2. Use the wall mount brackets to mount the gateway onto the wall mount

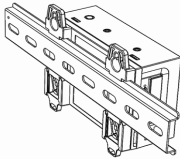

Wi-Fi Module and Antenna Installation

1. Remove the terminal plug. Use a flathead screwdriver to push the 2 side clips to release the rear cover

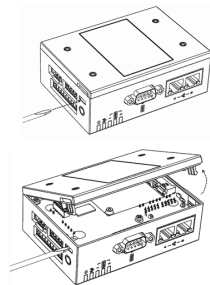
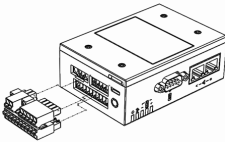

2. Loosen and remove the grounding screw

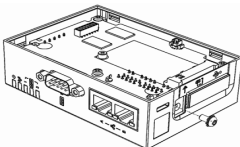

Wi-Fi Module and Antenna Installation

3. Loosen and remove the 2 COM port nuts

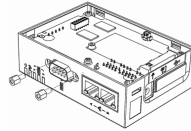

4. Loosen and remove the 2 screws on the main board

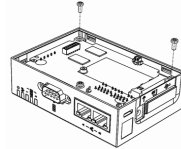

5. Remove the PCBA

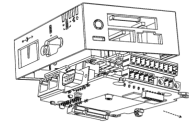

6. Remove the SMA dummy door as shown below

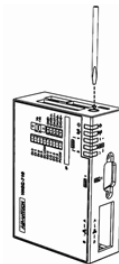

7. Use a socket wrench to connect an SMA cable

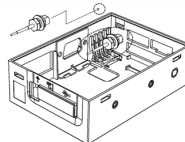

8. The SMA cable routing should be as shown below

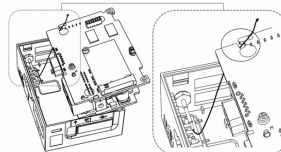

Wi-Fi Module and Antenna Installation

9. Install the PCBA as shown below

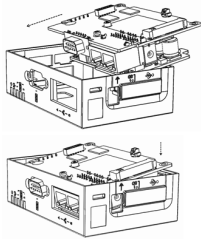

10. Affix the PCBA in place using 2 screws

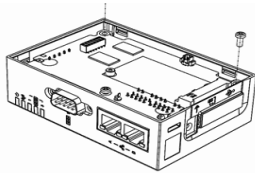

11. Replace the 2 COM port nuts

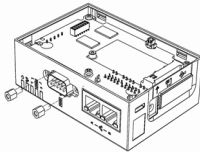

12. Fasten the GND screw

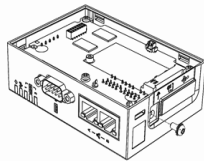

13. Insert the Wi-Fi module and affix it in place using 1 screw

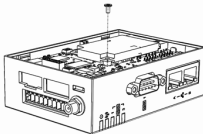

14. Plug the SMA cable into the wireless module

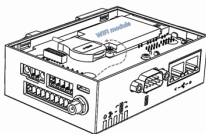

15. Replace the rear cover

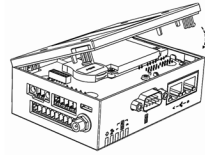

16. Affix the antenna to the antenna socket

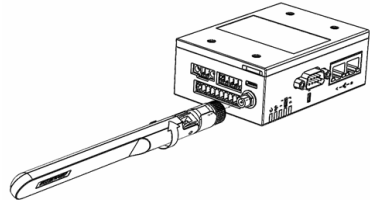

Expansion Module Installation

1. Remove the rear cover by using a flathead screwdriver to push and release the 2 side clips

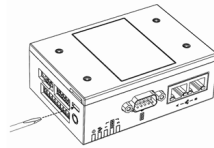

2. Connect the expansion module to the main board

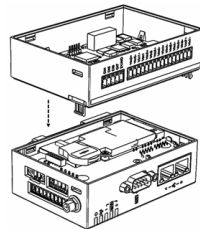

3. Replace the rear cover

